

## Power Amplifier

WR-12/71-76GHz/20dB Gain/26dBm Psat

Model: TMPA-071076-2026-12

TMPA-071076-2026-12 is a power amplifier with a typical gain of 20 dB and a nominal Psat of 26 dBm across the frequency range of 71 to 76 GHz. The DC power requirement for the amplifier is +12 VDC/400 mA. The input and output port configuration offers an inline structure with WR-12 waveguides and UG-387/U-M antcocking flanges.

### Features:

- Frequency range: 71-76GHz
- Gain: 20dB Typ
- Output Power Psat: 26dBm Typ
- Good Power and Gain Flatness

### Applications:

- Passive Imaging
- Communication Systems
- Radar Systems

### Electrical Characteristics:

Parameter	Min	Typ	Max	Units
Frequency range	71		76	GHz
Gain		20		dB
Output Psat		26		dBm
Input VSWR		1.6		:1
Output VSWR		1.6		:1
DC Voltage		12		V DC
DC Supply Current		400		mA

### Mechanical Specifications:

Parameter	Value	Units
Input /Output Connector	WR-12/UG-387/U	
DC Bias	Solder Pin	
Size	40*87*67 (With heatsink)	mm

### Absolute Maximum Ratings:

Parameter	Value
Supply Bias Voltage	+15 V
RF Input Power	+20 dBm
ESD sensitivity (HBm)	Class 0, passed 150V

### Outline Drawing:

Unit:mm; Tolerance:±0.1mm

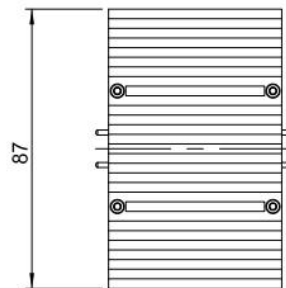
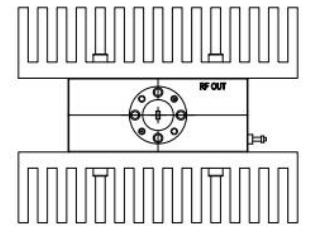
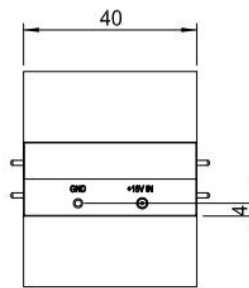
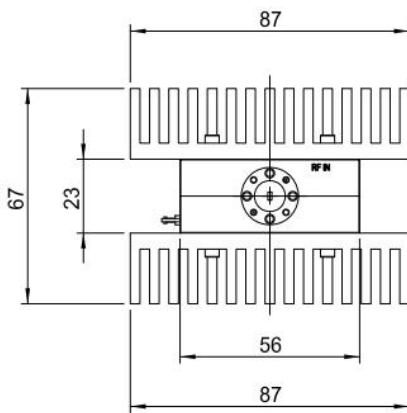

ESD Protection: Strictly adhere to ESD precautions to prevent electrostatic damage.

### Environmental Conditions:

Parameter	Min	Typ	Max	Units
Operating Temperature	-10		+65	°C
Non-operating Temperature	-45		+85	°C
Relative humidity		95		%
Altitude	10,000			feet
Shock / Vibration(MIL-STD-810F)	25g rms (15 degree 2KHz) endurance, 1 hour per axis			
Shock(non operating)	20G for 11msc half sin wave,3 axis both directions			

### Ordering Information:

Base Number	Description	Revision
TMPA-071076-2026-12	Power Amplifier, 71-76GHz, Gain: 20dB Type, P <sub>sat</sub> : 26dBm Type, +12V DC,WR-12	Rev.1.1

### Typical Performance Data:

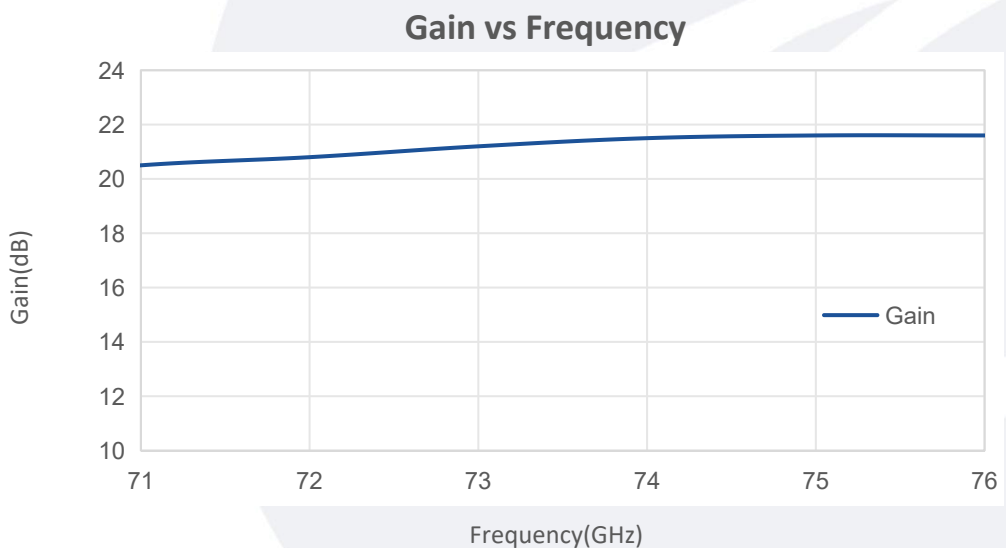

Note: Above data is for ref only, actual data may vary from unit to unit depending on operating environment and other factors like material lots etc.

## Typical Performance Data:

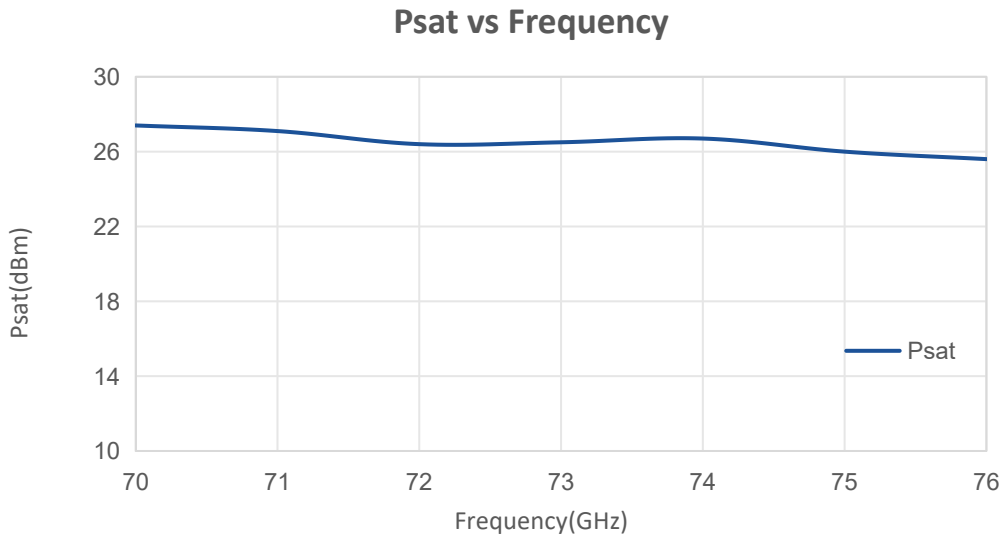

Note: Above data is for ref only, actual data may vary from unit to unit depending on operating environment and other factors like material lots etc.