

## Coaxial Fixed Attenuator

### SMA Female/DC-18GHz

Model: TAXXA50-S-18C-F

TAXXA50-S-18C-F is a 10//20/30/40 dB coaxial attenuator that is used in millimeterwave systems and operates from DC to 18 GHz.

#### Features:

- Operating Frequency DC to 18GHz
- Broadband Coverage
- Lost Cost

#### Applications:

- Test Lab
- Instrumentations
- System Integration

#### 电气特性 Electrical Characteristics:

参数 Parameter	Min	Typ	Max	单位 Units
频率范围 Frequency Range	DC		18	GHz
衰减范围 Attenuation Range		10 ±1.5		dB
		20±1.5		dB
		30±1.5		dB
		40±1.5		dB
驻波 VSWR			1.4	:1
阻抗 Impedance		50		Ohms
射频功率值 RF Power Rating*	50 Watts Average at 25°C; Peak: 500W (5 μSec Pulse Width , 5% Duty Cycle)			

\*Note: Average power linearly decreases to 10W when temperature rises to 125°C.

#### 环境和机械特性 Environmental And Physical Characteristics:

类型 Description	参数 Parameter	单位 Units
操作温度 Operating Temperature	-65~+125	°C
腔体材质 Body Material	Anodized Aluminum	
连接器材质 Connector Material	Stainless Steel Passivation	
内导体 Inner Conductor	Gold-plated, Beryllium Bronze	
接口 Connectors	SMA Female	
尺寸 Size	88.9*67*93.2	mm
重量 Weight	500	g

外形图 Outline Drawing:

Unit:mm

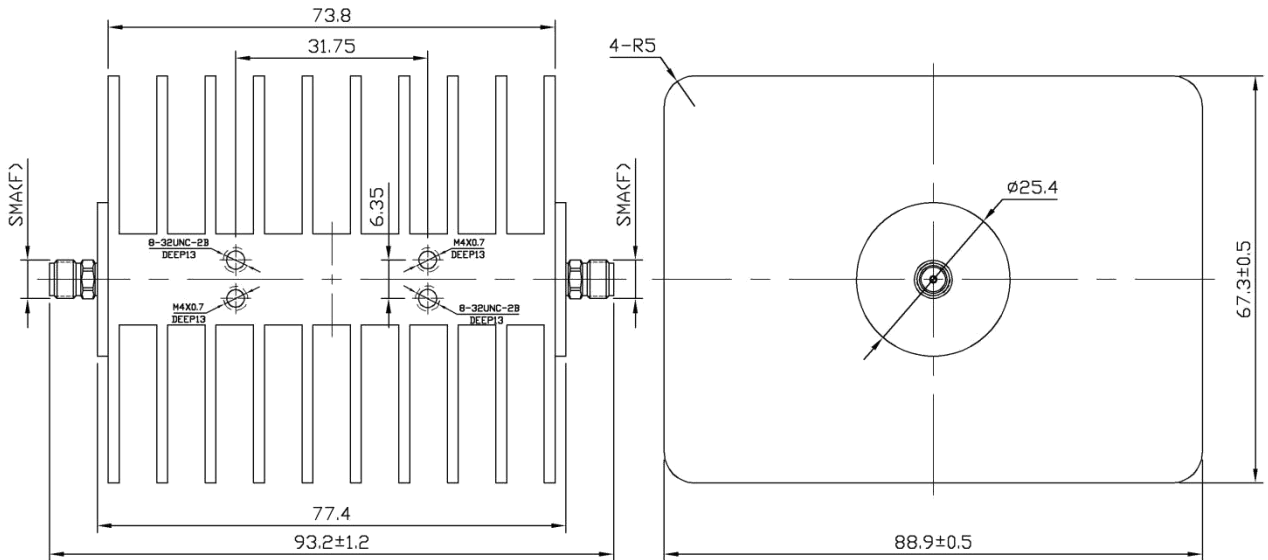

ESD Protection: Strictly adhere to ESD precautions to prevent electrostatic damage.

订货信息 Ordering Information:

标准型号 Base Number	描述 Description
TA10A50-S-18C-F	Coaxial Fixed Attenuator, DC-18GHz, 10±1.5dB Attenuation
TA20A50-S-18C-F	Coaxial Fixed Attenuator, DC-18GHz, 20±1.5dB Attenuation
TA30A50-S-18C-F	Coaxial Fixed Attenuator, DC-18GHz, 30±1.5dB Attenuation
TA40A50-S-18C-F	Coaxial Fixed Attenuator, DC-18GHz, 40±1.5dB Attenuation