

Dual Polarized Horn Antenna SMA Female/12-18GHz/15dBi Typ, Gain

Model:TL-120180DPHA15S

TL-120180DPHA15S is a dual polarized horn antenna that operates from 12 to 18GHz, The antenna offers 15 dBi typical gain. The antenna VSWR is 1.7:1 maximum. The antenna cross polarization isolation is minimum 25 dB. The antenna RF ports is SMA female. It can be widely used in EMI detection, orientation, reconnaissance, antenna gain and pattern measurement and other application fields.

Features:

- Operating Frequency 12 to 18 GHz
- Gain: 15 dBi Typ
- Dual Linear Polarization

Applications:

- Radar Systems
- Communication Systems

Electrical Characteristics:

Parameter	Min	Typ	Max	Units
Frequency Range	12		18	GHz
Gain		15		dBi
Polarization mode	Dual Linear			
Input VSWR			1.7	:1
Antenna Beamwidth			20	°
Cross Polarization Isolation	25			dB

Physical Characteristics:

Description	Parameter	Units
Material	Aluminum	
Finish	Conductive oxidation; spray sea gray paint	
Connectors	SMA Female	
Size	ø90*260	mm

Outline Drawing:

Unit:mm

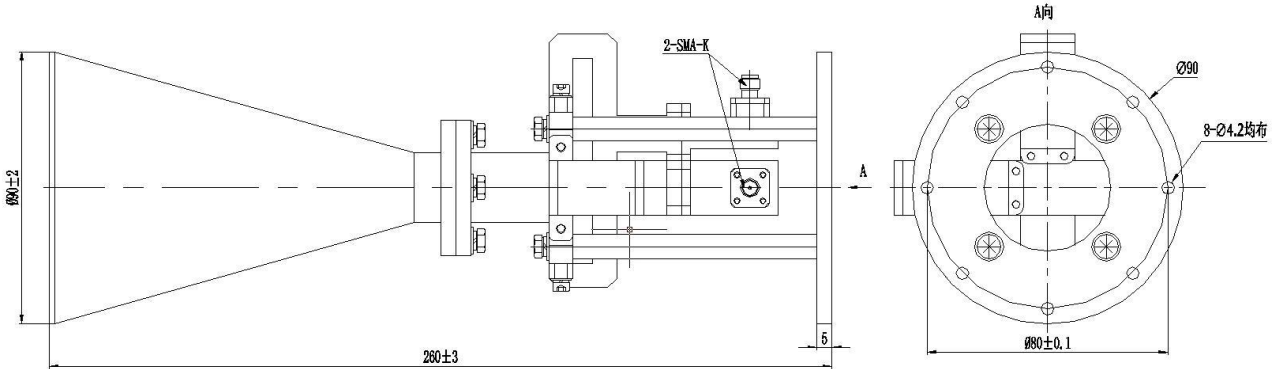

ESD Protection: Strictly adhere to ESD precautions to prevent electrostatic damage.

Ordering Information:

Base Number	Description	Revision
TL-120180DPHA15S	Dual Polarized Horn Antenna, 12-18GHz, Gain: 15 dBi Typ, SMA Female	Rev.1.1