

V-Band Reflective FET Switch

50-75 GHz/SPST/ WR-15

Model: TMS PST-050075-15

The TMS PST-050075-15 is a V-Band switch with a Negative logic level that operates between 50 and 75 GHz. The SPST switch offers 35 dB port-to-port isolation with a typical switching speed of 100 nanoseconds. The input and output connectors of the switch are WR-15.

Features:

- Frequency range: 50-75GHz
- Low Insertion Loss: 1.5dB
- Power Handling : 25 dBm
- High Isolation
- Switch Type: Reflective

Applications:

- Communication Systems
- Automatic Test Equipment
- Switching Network

Electrical Characteristics:

Parameter	Min	Typ	Max	Units
Frequency range		50-75		GHz
Insertion Loss		1.5		dB
Isolation		35		dB
Switch Speed		100		ns
Input VSWR		1.3		:1
Output VSWR		1.3		:1
P1dB Output P1dB		20		dBm
Control Voltage		-5V/0V		V
DC Supply Current		-100		mA
Switch type		Reflective		

Absolute Maximum Ratings :

Description	Parameter	Units
Control Voltage	-5 (+5%)	V
RF Input Power	25	dBm
ESD sensitivity (HBm)	Class 0, passed 150V	

Mechanical Specifications:

Description	Parameter	Units
Input /Output Connector	WR-15/UG-385/U	
Control Bias	Solder Pin	
Size	30*23*23	mm

Outline Drawing:

Unit:mm

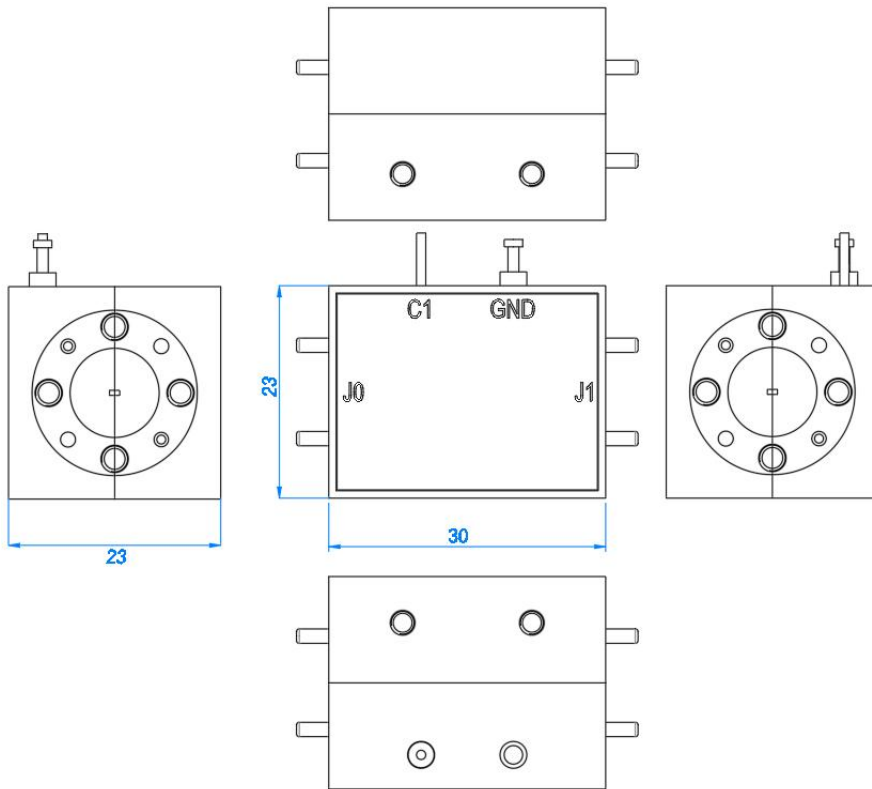

Truth Table	
Control Input Bit1	Signal Path State
-5V	ON
0	OFF



ESD Protection: Strictly adhere to ESD precautions to prevent electrostatic damage.

Environmental Conditions:

Parameter	Min	Typ	Max	Units
Operating Temperature	-45		+85	°C
Non-operating Temperature	-55		+125	°C
Relative humidity		95		%
Altitude	10,000			feet
Shock / Vibration(MIL-STD-810F)	25g rms (15 degree 2KHz) endurance, 1 hour per axis			
Shock(non operating)	20G for 11msc half sin wave,3 axis both directions			

Ordering Information:

Base Number	Description	Revision
TMSPST-050075-15	V-Band Reflective FET Switch 50-75 GHz,SPST,WR-15	Rev.1.1