

## Standard Gain Horn Antenna

WR-28/26.3-40GHz/15 dBi Typ, Gain

Model:TL-28SHA15

TL-28SHA15 is a standard gain horn antenna that operates from 26.3 GHz to 40 GHz. The antenna offers 15 dBi nominal gain. The input of this antenna is a WR28 waveguide with FBP320 anti-cocking flange. The standard gain horn is offered for antenna range calibration purpose mainly, but it can be also used for general purpose system set ups.

### Features:

- Operating Frequency 26.3 to 40 GHz
- Linear Polarization
- Good Impedance Match

### Applications:

- Antenna Ranges
- Antenna Gain Measurements
- System Setups

### Electrical Characteristics:



Parameter	Min	Typ	Max	Units
Frequency Range	26.3		40	GHz
Gain		15		dBi
Input VSWR			1.25	:1

### Environmental And Physical Characteristics:

Description	Parameter	Units
Material	Cpper	
Finish	Silver plated,Spray sea grey paint	
Connectors	WR-28(Connector is customizable)	
Size	26*19*35	mm

**Outline Drawing:**

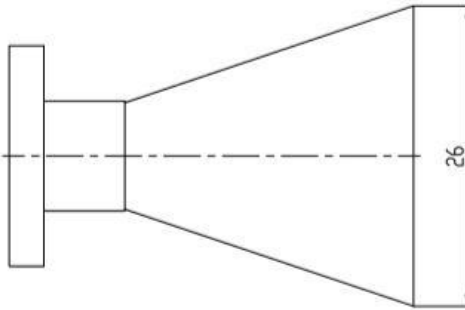
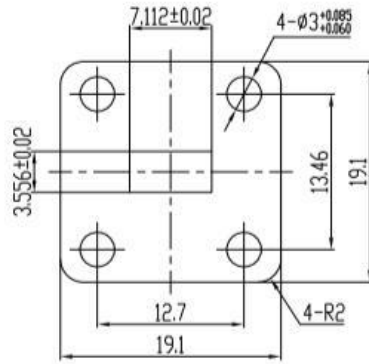
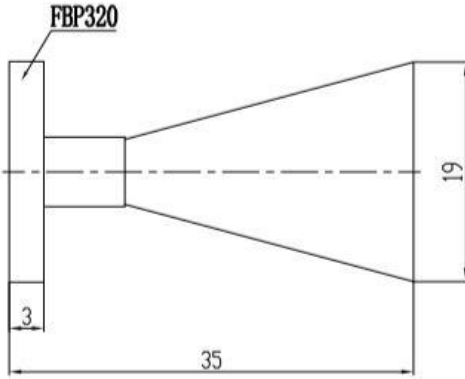
Unit:mm

ESD Protection: Strictly adhere to ESD precautions to prevent electrostatic damage.

**Ordering Information:**

Base Number	Description	Revision
TL-28SHA15	Standard Gain Horn Antenna, 26.3-40GHz, Gain: 15 dBi Typ.	Rev.1.0

**Typical Performance Data:**

**VSWR vs Frequency**

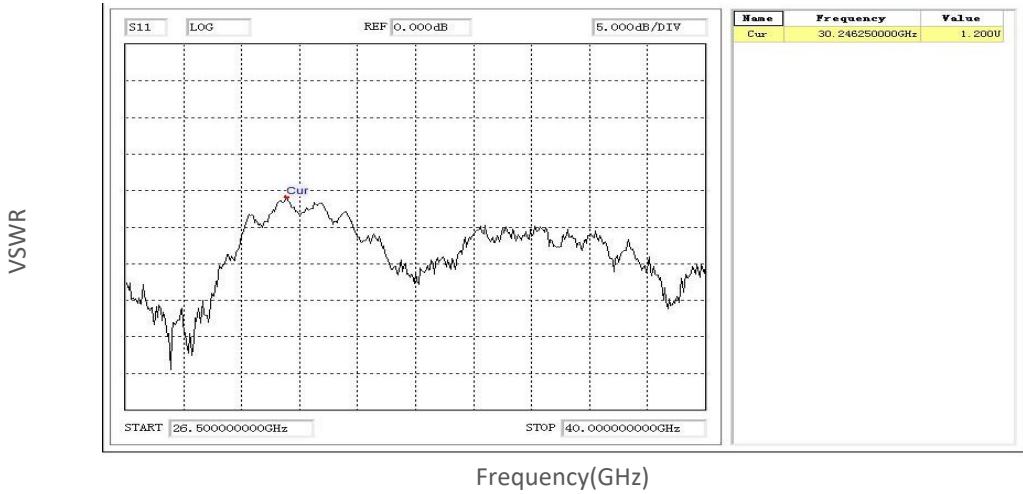

**Gain vs Frequency**

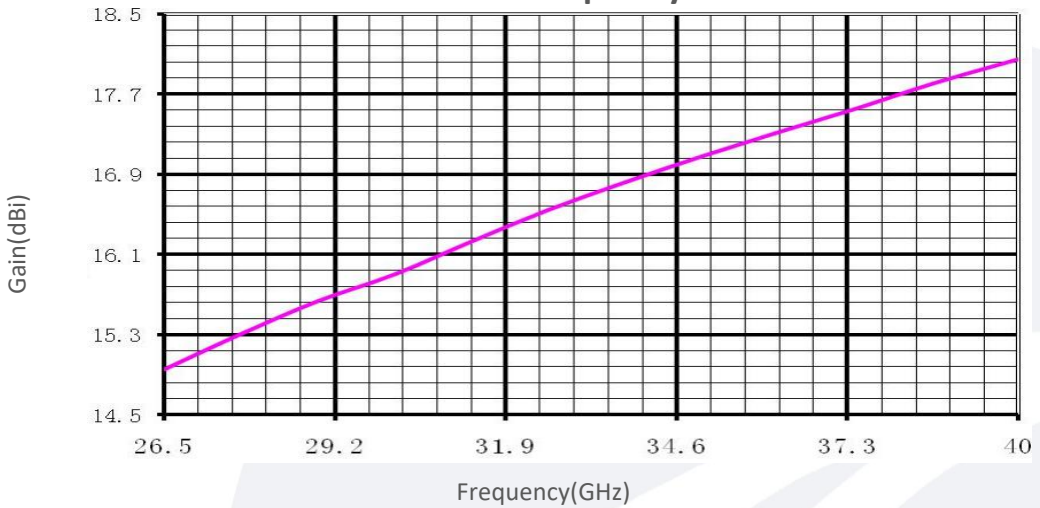

**26.3GHz:**

**Amplitude vs Theta**

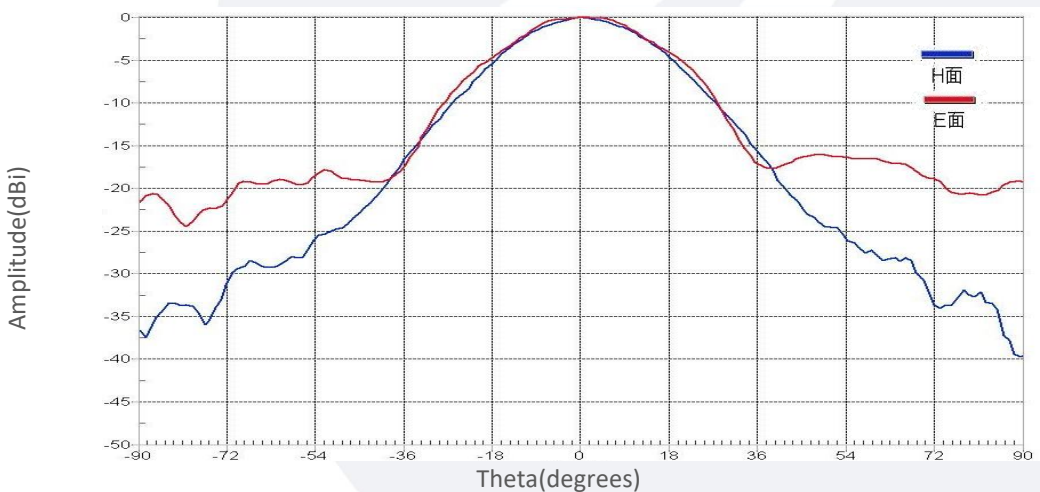

Note: Above data is for ref only, actual data may vary from unit to unit depending on operating environment and other factors like material lots etc.

## Typical Performance Data:

33.15GHz:

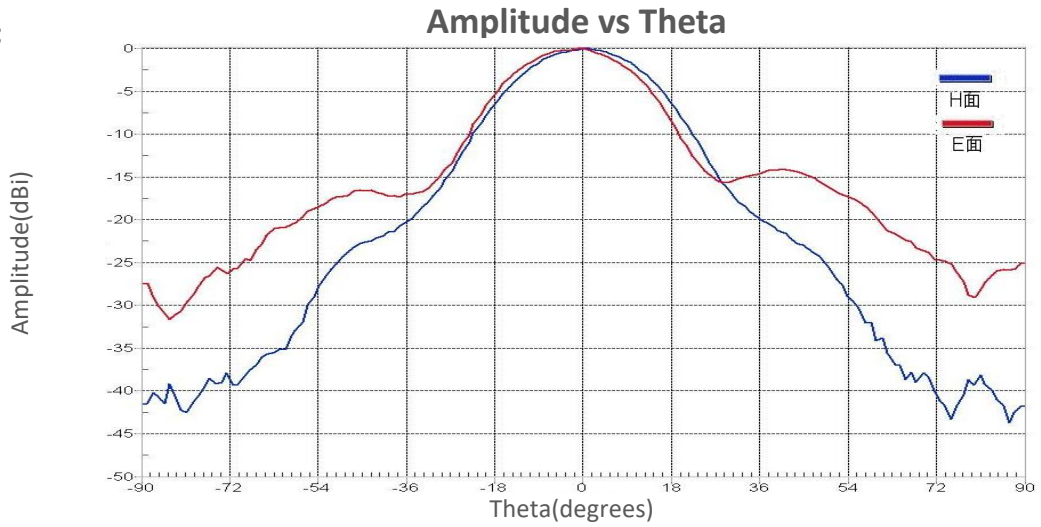

40GHz:

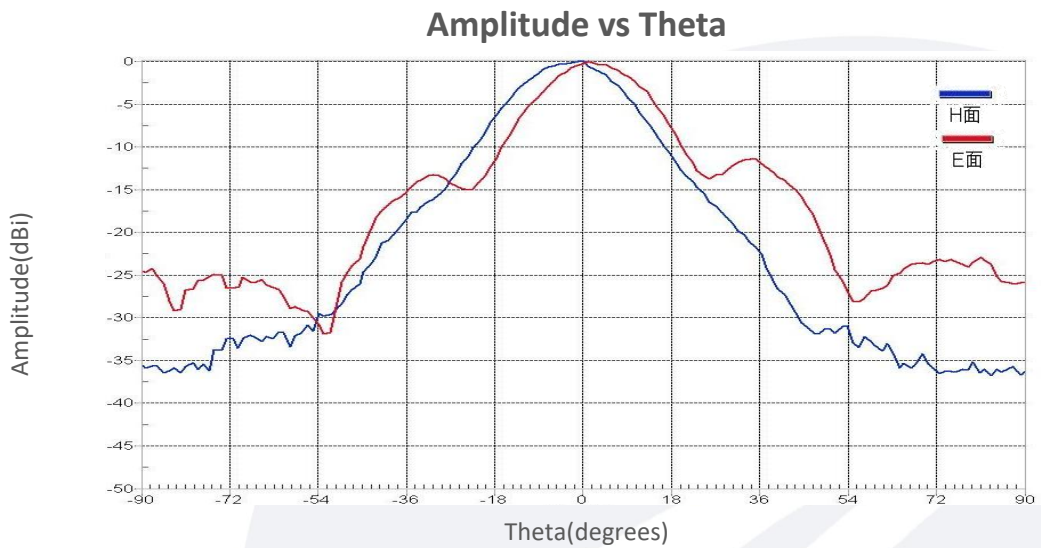

Note: Above data is for ref only, actual data may vary from unit to unit depending on operating environment and other factors like material lots etc.